

## Specification

Product Description	N Female Compression Connector for 1/2" Normal Cable	Date: 2020.07.21
Part NO.	AFA490-1	Ver. 3

UNIT: mm

## [Installation instructions](#)

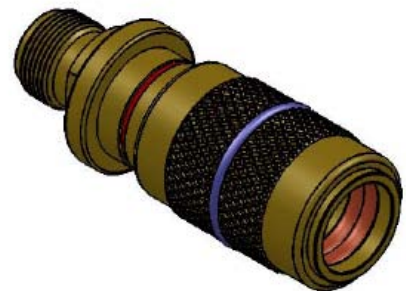
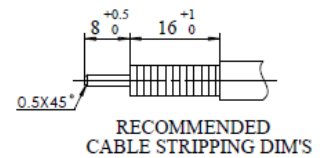
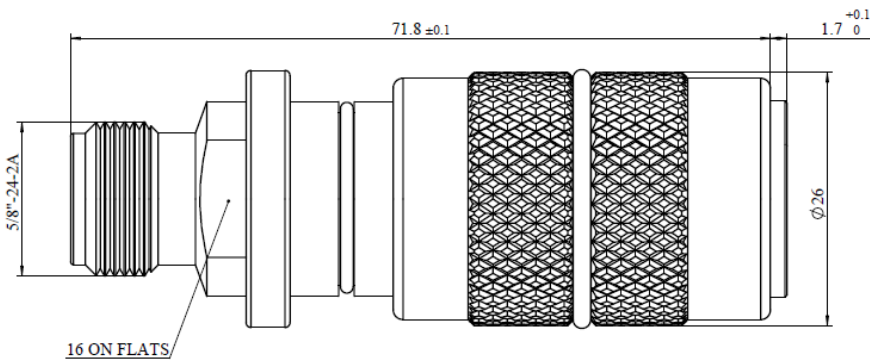

## Reference Standard

IEC61169-16

## Electrical Performance

Nominal Impedance ( $\Omega$ )	50
Frequency Range	DC-6GHz
VSWR	$\leq 1.10$ (0-3GHZ) $\leq 1.25$ (3-6GHZ)
PIM (dBc)	$\leq -160$ (2*43dBm)
Insertion Loss	$\leq 0.05\sqrt{F}$ (GHz)
Insulation Resistance(M $\Omega$ /500VDC)	$\geq 5000$
Proof Voltage (V/AC)	$\geq 2500$
Contact Resistance (m $\Omega$ )	$\leq 0.8$ (Inner Conductor) $\leq 0.4$ (Outer Conductor)

### Mechanical Performance

Interface Durability	500 Cycles
Retention	≥0.56N
Mating Cycles	500
Tensile Force (Cable-Connector)	500 N
Torsion (Cable-Connector)	3.5 N.m

### Material and Plating

Connector Parts	Material	Plating
Inner Conductor	Beryllium Bronze	Ag 3μm
Outer Conductor	Brass	Copper-tin-zinc 3μm
Insulator	TPX	
Gasket	Silicone Rubber	

### Environment

Temperature Range	-40°C~+85°C
Weather Standard	IEC60068 40/ 085/ 21
Thermal Shock	IEC60068-2-14-Na
Vibration	IEC60068-2-6-Fc
Shock	IEC60068-2-27
Waterproofing Standard	IP67
ROHS	Compliant(EU and China)

### Assembly

Inner conductor Installed and outer conductor Compressed.

Cable Supported	Cable Type Supported		Cable Supported	Cable Type Supported
Amphenol	AFY-50-12R		Andrew	LDF4-50A
Draka	RF1/2"-50		ANDREW	HL4RPV-50A (Plenum)
Eupen	EC4-50		RFS	ICA12-50JPLW (Plenum)
RFS	LCF12-50J			

NOTE: The technical specification contains proprietary information and such information may not be disclosed to others for any particular purpose or used for manufacturing purposes without written permission from Amphenol Fuyang.